

Grau

Apparatebau GmbH



— Nähapparate für Industriemaschinen —







— Nähapparate für Industriemaschinen

Index

1. product overview
2. information for our customer
3. straight on binder
4. folder / hemmer / double lap-felling attachment
5. casing device / piping attachment / cord guide
6. adjustable edge guide
7. parts list of Binder E256 30x6x1-02
8. parts list of S-3030-51



— Nähapparate für Industriemaschinen



binder

adjustable
edge
guide



special-
binder

cord
guide

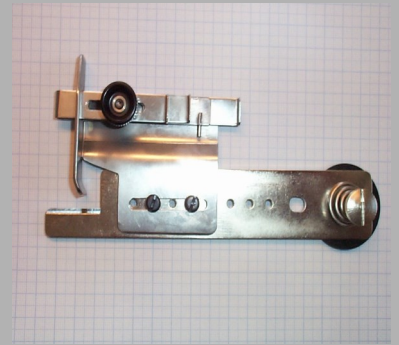

folder

belt
guide



pipings
attache-
ment

Special-
parts
on spezifi-
cation





— Nähapparate für Industriemaschinen

Dear Customer,

We have designed this Catalog for you, to have a short review about our manufacturing. We hope you enjoy the following pages. We're looking forward to work with you.

Important for your order!

With an order in devices or binders please send us a **sewing pattern or tape**. We cannot guarantee the function and quality of our devices or binders without a example. Also important is the sewing machine type.

If you order a binder please send use the number. You can see in the following example that the binder type is compound number.

without lock

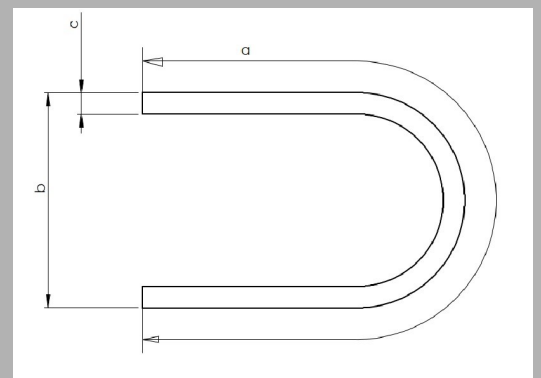

with lock

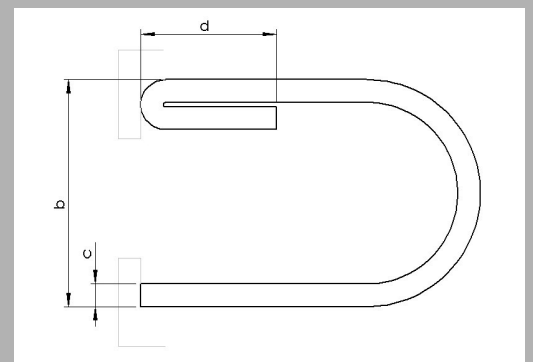

Example: Binder

E36 30x5x0,8

Dürkopp Adler Cl. 467/767

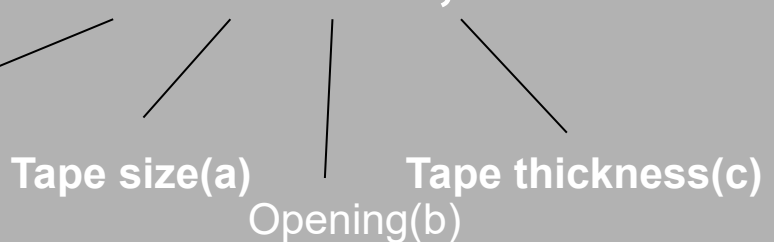



— Nähapparate für Industriemaschinen

straight on binder

in different sizes deliverable



E107
20x5x1
For DA
Cl. 67/ 167/ 267/
367/ 467/ 767

E101
26x7x2
For DA
Cl. 204/ 220/
221



straight on binder with offset

in different sizes deliverable



A-2100-24
30x5x0,8

A-2100-26
51x4x2



straight on binder with offset and core

in different sizes deliverable



A-2100-23
35x6x1

A-2100-55





— Nähapparate für Industriemaschinen

folder

in different sizes deliverable



U-25x1,5

U-10x1



hemmer

in different sizes deliverable



SÄ-
25x24x1

SÄ-
10x9x1



double lap-felling attachment

in different sizes deliverable



K-
13x1-01
bottom left
(bottom right -02)

K-
16x1,5-01
bottom left





— Nähapparate für Industriemaschinen

casing device

in different sizes deliverable



A-2303-00

piping attachment

in different sizes deliverable



A-2057-38

A-2057-41



cord guide

in different sizes deliverable



S-2007-31

S-2007-27

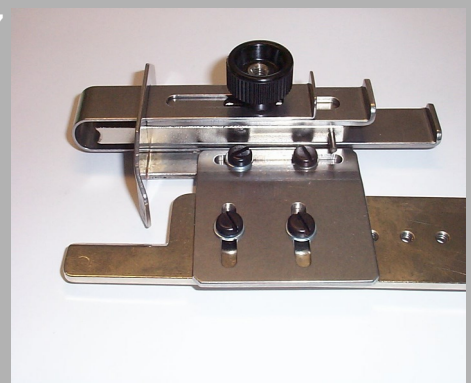



— Nähapparate für Industriemaschinen

adjustable edge guide

for all machine type deliverable

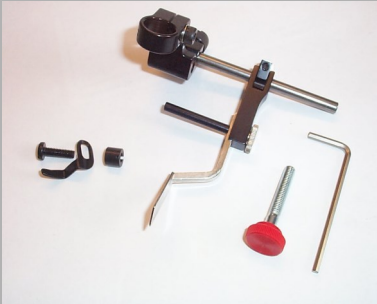

AN-1021-001
DA Cl. 212

AN-1039-00
for
fast sewing



AN-1039-00



AN-1021-10
DA Cl. 272

AN-1117-50
Juki DDL 9000
DDL 5550



AN-1117-50

adjustable edge guide heavy material

for all machine type deliverable



AN-1050-00
DA Cl. 291

AN-1074-00
Pfaff Cl. 1245/1425



AN-5001-30
DA Cl. 767

AN-1213-75
DA Cl. 867 / M-Type

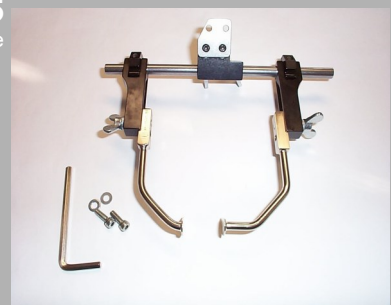

more adjustabel edge guide numbers
on our home-page



— Nähapparate für Industriemaschinen

parts liste: E256 30x6x1-

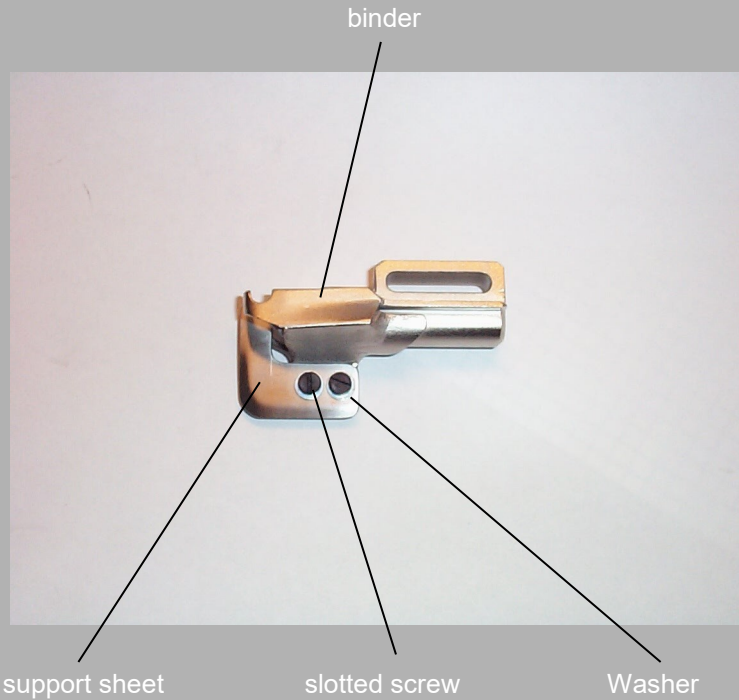

description	part-number	comment
Binder complete	E256 30x6x1-02	
Parts:		
binder	E256 30x6x1	
support sheet	E-0122-22	
Slotted screw	D00085.00302	DIN 85 M3 x 4
Washer	D00125.00300	DIN 125 M3



— Nähapparate für Industriemaschinen

parts list: S-3030-51

350mm disk and clamping piece

wing screw



grab handle with plate

coupling

rod

description	parts number	comment
Binding and tape reel Ø350mm	S-3030-51	
Einzelteile:		
coupling	S-3030-00-02	
rod	S-3030-00-03	Ø10x220
Grab handle with plate	S-3030-00-01	Ø10x250
Disk and clamping piece	S-3030-14	Ø350mm
Wing screw	K76.K01.00506	M5x10

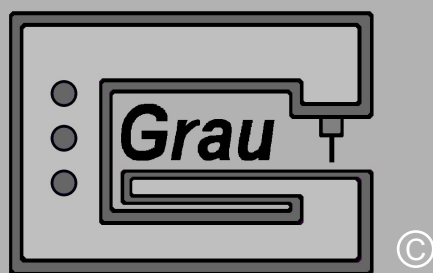

Grau Apparatebau GmbH - Heglestraße 24 - 73563 Möggingen - Germany
www.grau-apparatebau.de - info@grau-apparatebau.de

